

Series LHW

Manually Operated Pinch Valve



- ▶ Pre-pinch design provides linear flow characteristics
- ▶ Sleeve is the only wetted part
- ▶ No packing, seals or gaskets
- ▶ Inexpensive sleeve replacement
- ▶ Positive opening feature available
- ▶ Full-face tapered flanges



Series LHW Pinch Valves are operated by a handwheel that engages a direct-acting pinch mechanism to close the elastomeric sleeve from above. A patented positive opening feature ensures even and complete opening since the elastomeric sleeve is attached directly to the pinch bar. Over-pinching is prevented by a positive closure stop on the stem. The rugged elastomer sleeve easily outlasts metal valves on abrasive and corrosive applications.

No maintenance is required other than routine operator stem lubrication. Series LHW Pinch Valves are capable of extremely long cycling life, and replacement of the elastomeric sleeve is simple and inexpensive.

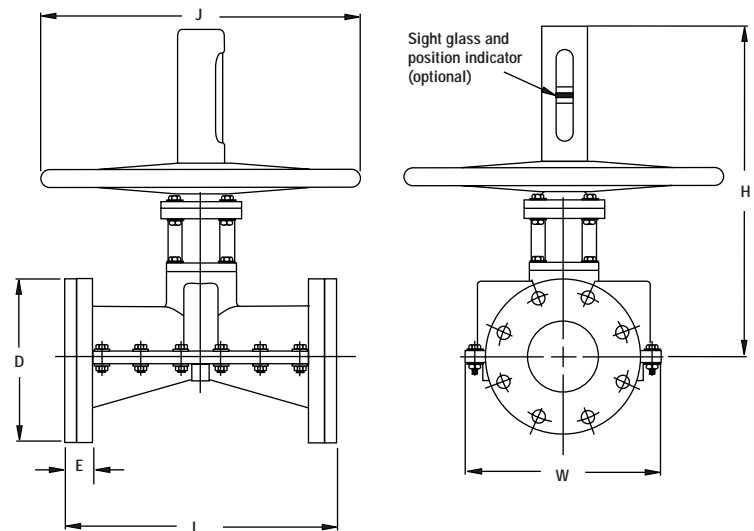

Materials of Construction

- ▶ ANSI Class 125/150
- ▶ Cast iron or aluminum body
- ▶ Sleeve available in Pure Gum Rubber, Neoprene, Hypalon®, Chlorobutyl, Buna-N EPDM and Viton®

Series LHW Pinch Valves

Valve Size	Length L	Width W	Height H	125/150 ANSI D	125/150 ANSI E	125/150 ANSI J	Max Working Pressure 125/150 ANSI psi	Weight Cast Iron lbs	Weight Aluminum lbs
1	6	5 1/4	8 7/8	4 1/4	1 1/16	6	200	14	5
1 1/2	6	6 1/8	9 3/4	5	1 1/8	6	200	15	6
2	8	7	10 1/8	6	1 7/16	7	200	30	13
2 1/2	10	8 7/8	13	7	1 1/2	7 3/4	175	38	17
3	12	10 1/4	13 1/4	7 1/2	1 9/16	7 3/4	175	50	24
4	16	12 1/8	17 3/4	9	1 11/16	10	150	100	45
5	15	13 1/4	18 5/8	10	1 3/4	12	125	160	74
6	18	15 7/8	19 1/8	11	1 7/8	14	125	160	74
8	24	18 3/4	26 3/8	13 1/2	2 1/8	16	125	260	141
10	30	22 1/2	28	16	2 7/16	20	100	385	190
12	36	27	36 1/8	19	2 3/4	24	100	620	311
14	42	29	37 3/8	21	3	28	75	825	450
16	48	33 3/4	46	23 1/2	3 3/4	32	75	1400	680