

Series SGE

Air Operated Pinch Valve



- ▶ Full-port opening
- ▶ Totally enclosed
- ▶ Pneumatically or hydraulically operated
- ▶ Long cycle life
- ▶ Easy, slip-on installation
- ▶ No maintenance
- ▶ Inexpensive sleeve replacement
- ▶ No moving parts

Series SGE Pinch Valves are operated by applying hydraulic or pneumatic pressure to the annular space surrounding the elastomeric sleeve. No external actuator is required. Other than the elastomeric sleeve, there are no moving parts in the Series SGE.

Air supply to close the valve must be approximately 20-30 PSI higher than line pressure in order to ensure full closure of the valve. Over pressurization may cause premature failure. Pneumatic or hydraulic pressure must be regulated.

Although primarily used in on-off service, SGE valves can provide approximate flow control using a booster relay. Vacuum conditions can be overcome by application of a vacuum generator or other vacuum source to fully open the valve.

Optional accessories include a pressure-reducing valve, a 3-way solenoid valve, air pressure gauge, booster relay and vacuum generator.



Materials of Construction

- ▶ Aluminum body
- ▶ Sleeve available in Pure Gum Rubber, Neoprene, Hypalon®, Chlorobutyl, Buna-N, EPDM and Viton®

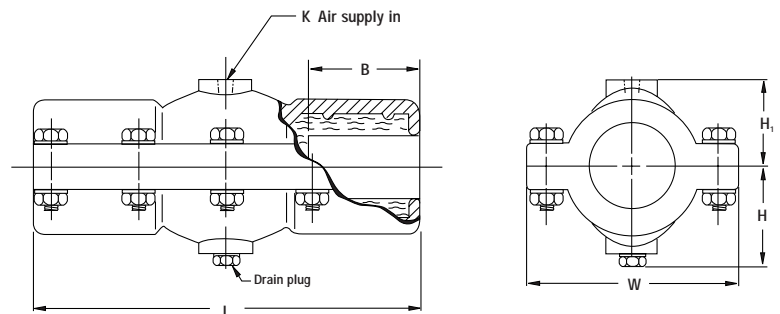

Series SGE Pinch Valves

Valve Size	Length L	Width W	Height		Port K NPT	B	Max Weight Aluminum lbs	Working Pressure psi
			H	H ₁				
1/4	4 7/8	2 3/4	1 3/8	1 1/16	1/8	1 7/16	1 1/2	50
1/2	5 3/4	3 1/4	1 9/16	1 1/4	1/8	1 11/16	1 3/4	50
3/4	6 3/4	3 1/2	1 3/4	1 7/16	1/8	1 13/16	3	50
1	7 3/16	4 1/8	2	1 11/16	1/4	2 3/32	4 1/2	50
1 1/4	8 1/2	4 1/2	2 5/16	2	1/4	2 1/2	5 1/2	50
1 1/2	10 1/4	4 3/4	2 1/2	2 3/16	1/4	3	7 1/2	50
2	11 3/4	5 1/2	2 15/16	2 5/8	1/4	3 1/8	10	50
2 1/2	14 1/4	6 5/8	3 1/2	3 3/16	1/4	3 5/8	21	35
3	16 1/4	7 1/2	4	3 5/8	1/4	4 1/8	24	35
4	20 1/4	8 3/4	5	4 5/8	1/4	5 1/8	38	35